

TRIUNA™ COLLECTION



GEIGER

TRIUNA COLLECTION

Designed by Manfred Petri, Triuna Collection embraces the shrinking footprint of modern executive workspaces, with design as imaginative as it is timeless. Triuna's elevated tops and signature knife-edge profile lighten the scale of the furniture—without compromising usable work surface or storage. Further distinguished by hand-inlaid wood marquetry and distinctive architectural trims, Triuna offers a progressive twist on classic style for today's private offices, reception areas and collaborative spaces.

FRONT COVER AND OPPOSITE: CREDENZA AND DESK IN QUARTER-CUT SYCAMORE, BLACK WOOD LIP PULLS, BLACK HORIZONTAL TRIM, BLACK SIMPLE LINE MARQUETRY, FORAY EXECUTIVE TASK CHAIR IN POLISHED ALUMINUM LOOP ARM



LUXURY AT WORK

TRIUNA FOR PRIVATE OFFICES. Elegant and versatile, Triuna adapts to both space-efficient and generously scaled private-office footprints with equal success. Legendary Geiger wood veneers, embellished with distinctive storage trim details and marquetry options, impart executive-level luxury; thoughtfully integrated power and technology options offer effortless connectivity. Available in custom-specified one-inch increments, Triuna creates private offices that precisely fit the work patterns of busy executives.



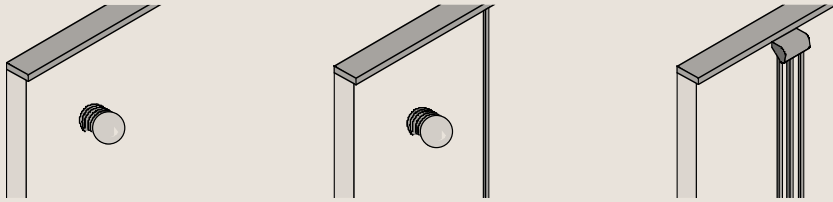

TRIUNA STORAGE UNITS WITH DOME PULLS CAN FEATURE HORIZONTAL TRIM (LEFT) OR SINGLE LINE TRIM (CENTER), WHILE UNITS WITH WOOD LIP PULLS CAN INCORPORATE TRIPLE LINE TRIM (RIGHT)



TRIUNA CREDENZA, OVERHEAD TOWER UNIT AND TRIUNA II ROUND TABLE IN NATURAL MAPLE
SATIN CHROME DOME PULLS
WALNUT GRID LINE TRIM

SEATING:
ATTACHÉ HIGH-BACK DESK CHAIR (LEFT)
COLLEGEVILLE GUEST CHAIR
AERON CHAIR (RIGHT)

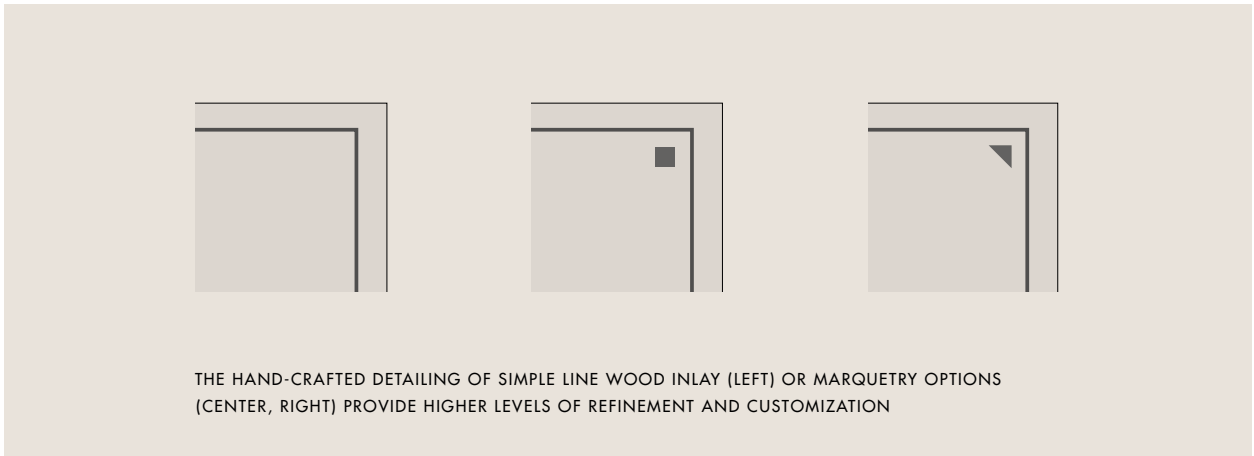

THE HAND-CRAFTED DETAILING OF SIMPLE LINE WOOD INLAY (LEFT) OR MARQUETRY OPTIONS (CENTER, RIGHT) PROVIDE HIGHER LEVELS OF REFINEMENT AND CUSTOMIZATION



ARC FRONT DESK, CREDENZA,
TOWER UNIT IN ANIGRE
BLACK DOME PULLS
BLACK GRID LINE TRIM
BLACK SQUARE MARQUETRY

SEATING:
ATTACHÉ HIGH-BACK DESK CHAIR



U-DESK AND CREDENZA IN CHERRY
BLACK DOME PULLS
BLACK SINGLE-LINE TRIM
EBONIZED PEARWOOD
SIMPLE LINE MARQUETRY

SEATING:
WAVELAND DESK CHAIR
ARBAT GUEST CHAIR

BASED ON A SMART ARRAY OF FUNCTIONAL
CORE ELEMENTS, TRIUNA OFFERS FOOTPRINTS
THAT FIT THE SCALE AND USAGE NEEDS OF
EVERY WORKSPACE

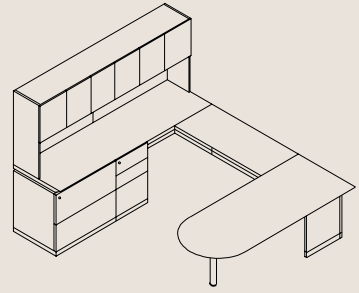
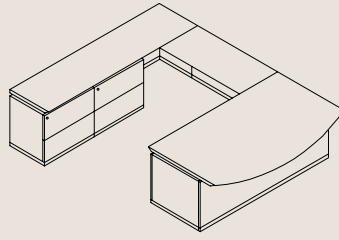

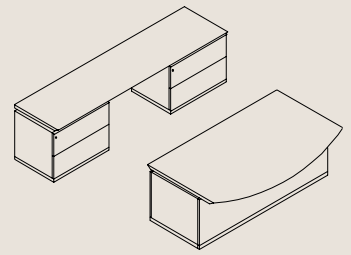
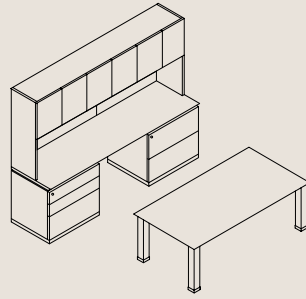
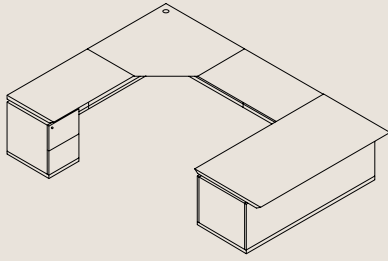

BULLET U-DESK IN SAPELE (CASES),
MAPLE (TOPS) AND CHERRY (EDGES)
BLACK DOME PULLS
CHERRY GRID LINE TRIM
BLACK SIMPLE LINE MARQUETRY

SEATING:
ATTACHÉ LOW-BACK DESK CHAIR

WELCOME FIRST IMPRESSIONS

TRIUNA FOR RECEPTION AREAS. With perfectly coordinated gallery desks and rear units, Triuna projects pride and continuity in corporate image—with just one look. Triuna provides an economical alternative to custom reception desks, inviting private-office luxury into public reception spaces. Personalized with the same premium Geiger veneer and custom details available on storage and work surfaces, Triuna gallery pieces make their own dramatic design statements while supporting a holistic office aesthetic.



RECEPTION STATION IN NATURAL FIGURED MAPLE
BLACK WOOD LIP PULLS
BLACK HORIZONTAL AND TRIPLE LINE TRIM
BLACK SIMPLE LINE MARQUETRY



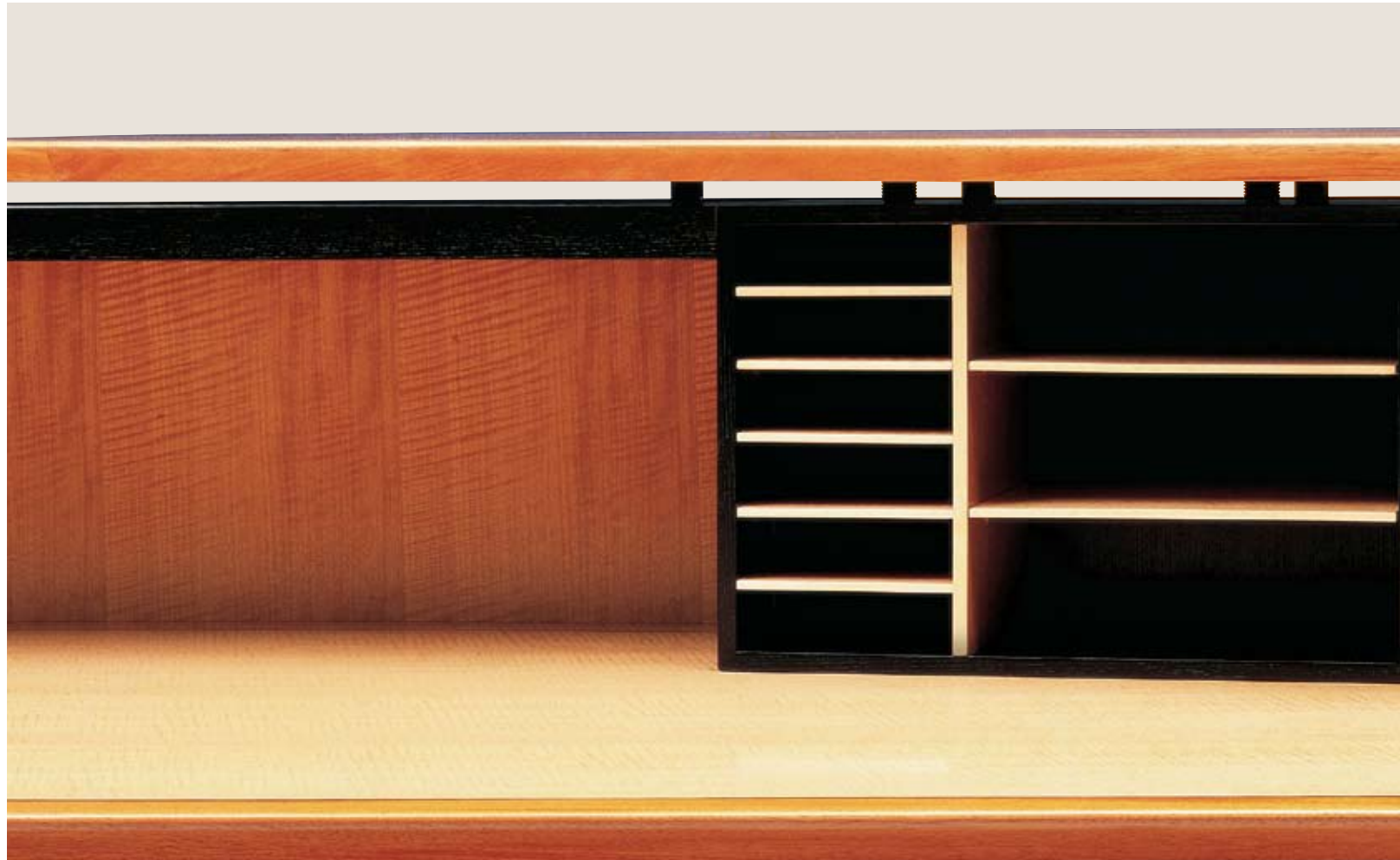



RECEPTION STATION IN QUARTER-CUT ANIGRE
BLACK DOME PULLS
BLACK SINGLE LINE TRIM
BLACK SIMPLE LINE MARQUETRY



RECEPTION STATION IN PEARWOOD
SATIN CHROME DOME PULLS
NATURAL CHERRY HORIZONTAL TRIM
NATURAL CHERRY SINGLE LINE TRIM



TAILORED TEAMWORK

TRIUNA FOR COLLABORATIVE SPACES. In functional group settings, Triuna meeting and occasional tables provide hardworking surfaces for teaming and meeting—whether a planned session or an impromptu brainstorm. Specify elegant Triuna marquetry and trim to match other Triuna offices, or introduce them as distinguishing features in collaborative settings. Either way, Triuna's refined details punctuate exquisitely finished, hand-selected Geiger veneers on surfaces designed for productivity and creativity.





SCARPA TABLES WITH DIAMOND, ROUND, SQUARE TOPS



TRIUNA II RECTANGULAR TABLE DESK
TRIUNA II ROUND TABLE

SEATING:
ATTACHÉ DESK CHAIR
COLLEGEVILLE GUEST CHAIR

GEIGER
INTERNATIONAL

800.444.8812

WWW.
GEIGERINTL
.COM

GEIGER

©2007 Geiger International, Inc. All rights reserved.

Geiger is a registered trademark of Geiger International, Inc.
The Geiger logo, Attaché, Arbat, Collegeville, Triuna and
Waveland are trademarks of Geiger International, Inc.
Aeron is a registered trademark and Foray is a trademark
of Herman Miller, Inc. All other trademarks and registered
trademarks are property of their respective companies.

Serial #07C005